



Navojni zatici



www.imbus.hr



**SPECIJALIZIRANA
TRGOVINA VIJCIMA**



Navojni zatici

KATALOG

Component suitable for all trades, usable anywhere:

- 1 manufacturing of devices and tools
- 1 electrical and machinery industries
- 1 construction of plant and apparatus
- 1 locking systems, household appliances, medical equipment
- 1 and much more

The appropriate material for every case:

- 1 steel
- 1 stainless steel
- 1 plastic
- 1 springs are always in stainless steel



Pressure screws are used to

- 1 fix components which have to be changed quickly and frequently, e.g. bladeholders, bulbholders and various types of locking elements
- 1 to position dimensionally accurate distances e.g. for stops
- 1 allowing play in the manufacture of gauges, devices and tools
- 1 positioning in linear and radial movements e.g. for sliders and tripping latches in the manufacture of tools, machinery and apparatus
- 1 locking movable components, e.g. for top-hung windows, doors
- 1 centering of aligning elements, e.g. for shafts, bushes, bearings
- 1 fine adjustment, e.g. for indexing mechanism
- 1 slipping into the correct position, e.g. for variable travel limiting in packaging machinery

The solution for every design case

- 1 with threads from M3 to M20
- 1 for pressing in \varnothing 4 to 8 mm
- 1 with ball or bolt
- 1 with slot or with hexagon socket
- 1 special parts prepared to customers' requests
- 1 also with defined spring pressure (to customers' requests)

– Standard program

with ball and slot EH 2204

1 BN 13377

sleeve - POM blue
ball - hardened stainless steel
spring - stainless steel

d_1	BN 13377 Code	BN 13378 Code	l	a	d_2	initial force F_1 ~N	ending force F_2 ~N	
M6	2204006	2204406	14	1	3,5	12	17	1 1
M8	2204008	2204408	16	1,5	5	20	35	1 1
M10	2204010	2204410	19	2	6	25	45	1 1

1 BN 13378

sleeve - POM blue
ball - POM white
spring - stainless steel

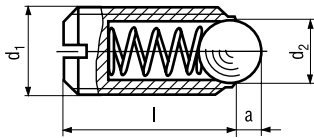

with ball and hexagon socket

EH 2203 (standard spring force)

1 BN 20199

sleeve - free cutting steel, black-finished, d_1
ball - ball-bearing steel, hardened
spring - stainless steel

d_1	BN 20199 Code	BN 20201 Code	l	a	d_2	initial force F_1 ~N	ending force F_2 ~N	
M4	2203004	2203204	12	0,8	2,5	8,5	14	1 1
M5	2203005	2203205	14	0,9	3	8	14	1 1
M6	2203006	2203206	15	1	3,5	11	18	1 1
M8	2203008	2203208	18	1,5	4,5	18	31	1 1
M10	2203010	2203210	23	2	6	24	45	1 1
M12	2203012	2203212	26	2,5	8	26	49	1 1

1 BN 20201

sleeve - stainless steel 1.4305
ball - bearing steel, hardened
spring - stainless steel

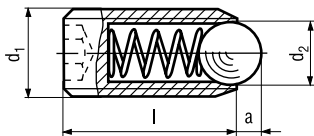

with ball and hexagon socket

EH 2203 (increased spring force)

1 BN 20200

sleeve - free cutting steel, black-finished, d_1
ball - bearing steel, hardened, yellow
spring - stainless steel

d_1	BN 20200 Code	BN 20202 Code	l	a	d_2	initial force F_1 ~N	ending force F_2 ~N	
M5	2203045	2203245	14	0,9	3	15	22	1 1
M6	2203046	2203246	15	1	3,5	19	28	1 1
M8	2203048	2203248	18	1,5	4,5	36	62	1 1
M10	2203050	2203250	23	2	6	57	104	1 1
M12	2203052	2203252	26	2,5	8	61	110	1

1 BN 20202

sleeve - stainless steel 1.4305
sleeve end yellow
ball - hardened stainless steel
spring - stainless steel

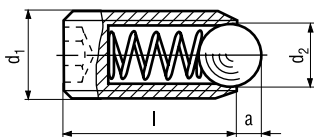

with ball and slot EH 2205 (standard spring force)

1 **BN 13363**

sleeve – free cutting steel, black-finished, d_1
 ball - ball-bearing steel, hardened
 spring - stainless steel

BN 13363
Code

BN 13370
Code

l

a

d_2

initial
force F_1
~N

ending
force F_2
~N

	Code	Code	l	a	d_2	initial force F_1 ~N	ending force F_2 ~N	
M3	2005003	2005403	7	0,4	1,5	3	4,5	1 1
M4	2005004	2005404	9	0,8	2,5	8,5	14	1 1
M5	2005005	2005405	12	0,9	3	8	14	1 1
M6	2005006	2005406	14	1	3,5	11	18	1 1
M8	2005008	2005408	16	1,5	4,5	18	31	1 1
M10	2005010	2005410	19	2	6	24	45	1 1
M12	2005012	2005412	22	2,5	8	26	49	1 1
M16	2005016	2005416	24	3,5	10	41	86	1 1
M20	2005020	2005420	30	4,5	12	56	111	1 1

1 **BN 13370**

sleeve - stainless steel 1.4305
 ball - hardened stainless steel
 spring - stainless steel

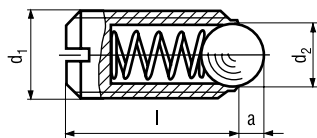

with ball and slot EH 2205 (increased spring force)

1 **BN 13364**

sleeve – free cutting steel, black-finished, d_1
 ball - yellow, ball-bearing steel, hardened
 spring - stainless steel

BN 13364
Code

BN 13371
Code

l

a

d_2

initial
force F_1
~N

ending
force F_2
~N

	Code	Code	l	a	d_2	initial force F_1 ~N	ending force F_2 ~N	
M5	2205205	2205605	12	0,9	3	15	22	1 1
M6	2205206	2205606	14	1	3,5	19	28	1 1
M8	2205208	2205608	16	1,5	4,5	36	62	1 1
M10	2205210	2205610	19	2	6	57	104	1 1
M12	2205212	2205612	22	2,5	8	61	110	1 1
M16	2205216	2205616	24	3,5	10	68	142	1 1
M20	2205220	2205620	30	4,5	12	84	166	1 1

1 **BN 13371**

sleeve - stainless steel 1.4305
 sleeve ends yellow
 ball - hardened stainless steel
 spring - stainless steel

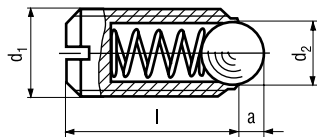

with ball and slot EH 2205 (standard spring force)

1 **BN 13365**

sleeve – free cutting steel, black-finished, d_1
 bolt – free cutting steel hardened, black-finished
 spring - stainless steel

BN 13365
Code

BN 13372
Code

l

a

d_2

initial
force F_1
~N

ending
force F_2
~N

	Code	Code	l	a	d_2	initial force F_1 ~N	ending force F_2 ~N	
M4	2205104	2205504	9	1,5	1,8	4,5	12,5	1 1
M5	2205105	2205505	12	2	2,4	5	13	1 1
M6	2205106	2205506	14	2	2,7	6	17	1 1
M8	2205108	2205508	16	2	3,8	16	33	1 1
M10	2205110	2205510	19	2,5	4,5	19	42	1 1
M12	2205112	2205512	22	3,5	6,2	22	57	1 1
M16	2205116	2205516	24	4,5	8,5	38	78	1 1

1 **BN 13372**

sleeve - stainless steel 1.4305
 bolt - stainless steel 1.4305
 spring - stainless steel

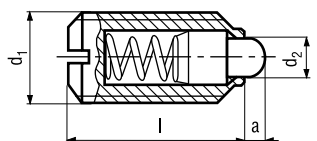

with ball and slot EH 2205 (increased spring force)

1 BN 13366

sleeve – free cutting steel, black-finished, d_1
 bolt – free cutting steel hardened,
 blue-galvanized
 spring – stainless steel

BN 13366

BN 13373

l

a

d_2

initial
force F_1
~N

ending
force F_2
~N

	Code	Code	l	a	d_2	initial force F_1 ~N	ending force F_2 ~N	
M6	2205306	2205706	14	2	2,7	11	25	1 1
M8	2205308	2205708	16	2	3,8	23	59	1 1
M10	2205310	2205710	19	2,5	4,5	20	54	1 1
M12	2205312	2205712	22	3,5	6,2	38	96	1 1
M16	2205316	2205716	24	4,5	8,5	50	100	1 1

1 BN 13373

sleeve - stainless steel 1.4305,
 sleeve ends yellow
 bolt - stainless steel 1.4305
 spring - stainless steel

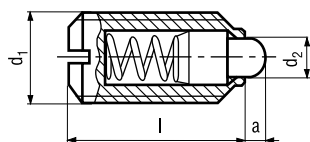

with ball and cylindrical head with slot EH 2205 (standard spring force)

1 BN 20203

sleeve – free cutting steel, black-finished, d_1
 ball - ball-bearing steel, hardened
 spring - stainless steel

BN 20203

BN 20204

l

l_1

a

d_2

initial
force F_1
~N

ending
force F_2
~N

	Code	Code	l	l_1	a	d_2	d_3	initial force F_1 ~N	ending force F_2 ~N	
M4	2205930	2205940	6,5	9,5	0,8	2,5	6	8	14	1 1
M5	2205931	2205941	8,5	12,5	0,9	3	8	8	14	1 1
M6	2205932	2205942	9	14	1	3,5	10	11	18	1 1
M8	2205933	2205943	11	16,5	1,5	4,5	13	18	31	1 1
M10	2205934	2205944	14	20	2	6	16	24	45	1 1

1 BN 20204

sleeve - stainless steel 1.4305
 ball - hardened stainless steel
 spring - stainless steel

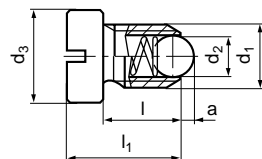

with bolt and grub screw with hexagon socket bonded EH 2206 (standard spring force)

1 BN 13367

sleeve – free cutting steel, black-finished, d_1
 bolt – free cutting steel hardened,
 black-finished
 spring - stainless steel

BN 13367

l

a

d_2

n

t

initial
force F_1
~N

ending
force F_2
~N

	Code	l	a	d_2	n	t	s	initial force F_1 ~N	ending force F_2 ~N	
M3	2206003	12	1	1	0,4	0,5	0,7	2	4	1
M4	2206004	15	1,5	1,5	0,6	0,6	1,3	4,5	16	1
M5	2206005	18	2,3	2,4	1,2	0,8	1,5	6	19	1
M6	2206006	20	2,5	2,7	1,3	0,9	2	6	19	1
M8	2206008	22	3	3,5	1,5	1,4	2,5	10	39	1
M10	2206010	22	3	4	1,5	1,4	3	10	39	1
M12	2206012	28	4	6	2,7	2	4	12	53	1
M16	2206016	32	5	7,5	3,2	2,5	5	45	100	1
M20	2206020	40	7	10	3,7	3	6	52	125	1

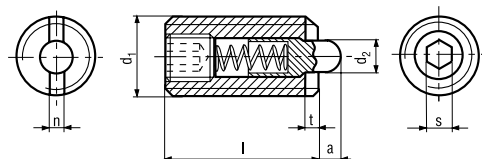

with bolt and grub screw with hexagon socket bonded

EH 2206 (increased spring force)

1 BN 13368

sleeve – free cutting steel, black-finished d_1
 bolt – free cutting steel hardened,
 black-finished
 spring - stainless steel
 grub screw - plain

	BN 13368	l	a	d_2	n	t	s	initial force F_1 ~N	ending force F_2 ~N	
	Code									
M5	2206105	18	2,3	2,4	1,2	0,8	1,5	11	40	1
M6	2206106	20	2,5	2,7	1,3	0,9	2	15	43	1
M8	2206108	22	3	3,5	1,5	1,4	2,5	20	75	1
M10	2206110	22	3	4	1,5	1,4	3	20	75	1
M12	2206112	28	4	6	2,7	2	4	45	120	1
M16	2206116	32	5	7,5	3,2	2,5	5	64	160	1
M20	2206120	40	7	10	3,7	3	6	75	195	1

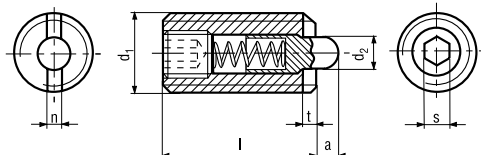

with bolt and grub screw with hexagon socket bonded

EH 2206 (standard spring force)

1 BN 13369

sleeve – free cutting steel, black-finished d_1
 bolt - POM white
 spring - stainless steel

	BN 13369	BN 13374	BN 13375	l	a	d_2	n	t	s	initial force F_1 ~N	ending force F_2 ~N	
	Code	Code	Code									
M4	2206204	2206404	2206604	15	1,5	1,5	0,6	0,6	1,3	4,5	16	1 1 0
M5	2206205	2206405	2206605	18	2,3	2,4	1,2	0,8	1,5	6	19	1 1 0
M6	2206206	2206406	2206606	20	2,5	2,7	1,3	0,9	2	6	19	1 1 0
M8	2206208	2206408	2206608	22	3	3,5	1,5	1,4	2,5	10	39	1 1 0
M10	2206210	2206410	2206610	22	3	4	1,5	1,4	3	10	39	1 1 0
M12	2206212	2206412	2206612	28	4	6	2,7	2	4	12	53	1 1 0
M16	2206216	2206416	2206616	32	5	7,5	3,2	2,5	5	45	100	1 1 0

1 BN 13374

sleeve - stainless steel 1.4305
 bolt - stainless steel 1.4305
 spring - stainless steel

0 BN 13375

sleeve - stainless steel 1.4305
 bolt - POM white
 spring - stainless steel

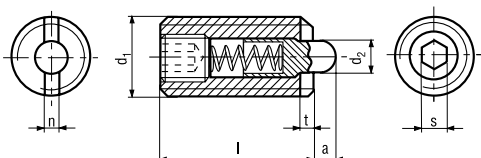

Smooth design with collar

EH 2208

1 BN 13376

sleeve - stainless steel 1.4303
 ball - hardened stainless steel
 spring - stainless steel
 mounting hole tolerance H7 to H8

	BN 13376	d_2	d_3	l_1	l_2	a	initial force F_1 ~N	ending force F_2 ~N	
	Code								
Ø 4	2208004	3	4,6	5	1	1	2,5	6	1
Ø 5	2208005	4	5,6	6	1	1,4	3	6,5	1
Ø 6	2208006	5	6,5	7	1	1,8	5,5	11,5	1
Ø 8	2208008	6,5	8,5	9	1	2,4	7	12,5	1

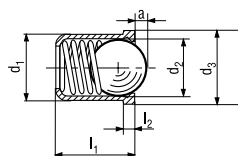

smooth design with collar EH 2208

- 1 **BN 13379**
 sleeve - POM blue
 ball - hardened stainless steel
 spring - stainless steel

d_1	BN 13379	BN 13380	d_2	d_3	l_1	l_2	a	initial force F_1 ~N	ending force F_2 ~N	
	Code	Code								
Ø 4	2208404	2208604	3	4,6	5	1	0,8	2,5	6,5	1
Ø 5	2208405	2208605	4	5,6	6	1	1	4,5	9	1
Ø 6	2208406	2208606	5	6,5	7	1	1,6	6,5	13	1
Ø 8	2208408	2208608	6,5	8,5	9	1	1,9	8	18	1

- 1 **BN 13380**
 sleeve - POM blue
 ball - POM white
 spring - stainless steel
 mounting hole tolerance H7 to H8

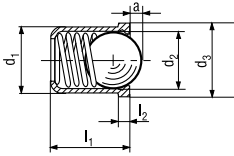

smooth design without collar EH 2208

- 1 **BN 20205**
 sleeve - stainless steel 1.4305
 ball - hardened stainless steel
 spring - stainless steel
 tolerance of diameter d_1 +/- 0.04

d_1	BN 20205	l	a	d_2	initial force F_1 ~N	ending force F_2 ~N	
	Code						
Ø 3	2208310	7	0,65	2	4,5	7,5	1
Ø 3,5	2208312	9	0,8	2,5	6	14,5	1
Ø 4	2208315	11	0,9	3	8	14	1
Ø 4,5	2208317	12	0,95	3,2	9,5	16,5	1
Ø 5	2208320	13	1	3,5	11	18	1
Ø 5,5	2208322	14	1,2	4	15,5	25	1
Ø 6	2208325	15	1,5	4,5	18	31	1

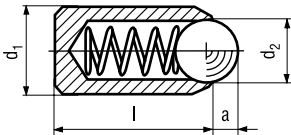

double-sided EH 2209

- 1 **BN 20206**
 copper sleeve (centre rimmed)
 ball - hardened stainless steel
 spring - stainless steel

d_1	BN 20206	l_1	a	d_2	d_3 min.	initial force F_1 ~N	ending force F_2 ~N	
	Code							
Ø 2,5	2209025	5,3	0,65	2	2,52	1,3	2,5	1
Ø 3	2209030	7,3	0,8	2,5	3,02	2	4,5	1
Ø 4	2209040	9	0,9	3	4,03	2,5	7,5	1
Ø 5	2209050	10,8	1,2	4	5,03	3,5	8	1
Ø 7	2209070	14	2	6	7,03	4	12	1
Ø 8	2209080	18	2,1	6,5	8,03	6	15	1

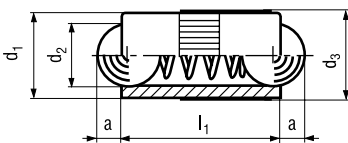

Ball plungers / screwdriver

Without head, full ball EH 2272

1 BN 20214	d ₁	BN 20214	l	static load	
screw - steel hardened and tempered 1200 ± 100 N/mm ²		Code		max. kN	
ball - ball-bearing steel, hardened	M4	2272042	6	3,5	1
		2272043	8	3,5	1
		2272044	10	3,5	1
		2272045	12	3,5	1
		2272046	16	3,5	1
	M5	2272052	8	4,5	1
		2272053	10	4,5	1
		2272054	12	4,5	1
		2272055	16	4,5	1
		2272056	20	4,5	1
		2272058	25	4,5	1
	M6	2272062	10,8	9	1
		2272063	12,8	9	1
		2272064	16,8	9	1
		2272065	20,8	9	1
		2272066	25,8	9	1
	M8	2272081	11,2	15	1
		2272082	13,2	15	1
		2272083	17,2	15	1
		2272084	21,2	15	1
		2272085	26,2	15	1
		2272086	31,2	15	1
	M10	2272101	13,7	20	1
		2272102	17,7	20	1
		2272103	21,7	20	1
		2272104	26,7	20	1
		2272105	31,7	20	1
		2272106	36,7	20	1
		2272108	41,7	20	1

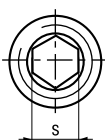
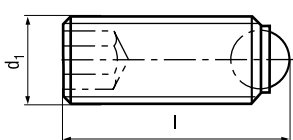

Screwdriver to EH 2206

1 BN 16007	Size	order number	l ₁	l ₂	
	M3	2206.803	60	135	1
	M4	2206.804	75	155	1
	M5	2206.805	85	175	1
	M6	2206.806	85	175	1
	M8	2206.808	95	195	1
	M10	2206.810	105	205	1
	M12	2206.812	105	230	1
	M16	2206.816	115	265	1
	M20	2206.820	115	265	1

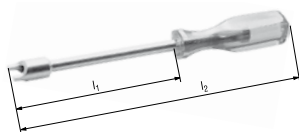

www.imbus.hr